

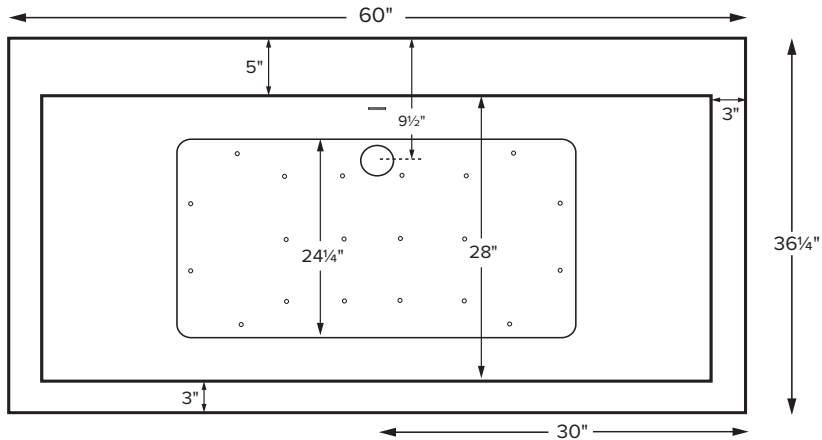

Available as a freestanding model or finished on 1, 2 or 3 sides for various installation applications.

**Kahlo 1**  
with Sculpted Finish®

<b>MODEL 119A</b>	
<b>60" x 36.25" x 22.5"</b>	
<b>FREESTANDING or ALCOVE</b> 72 gal to overflow	
<b>Acrylic CXL®</b>	<b>DoloMatte®</b>
160 lbs / 73 kg	<SOAKER> 180 lbs / 82 kg
Filling this tub to the maximum may require an above average size or dedicated water heater.	



Features a flat 5" deck surface on the drain side for mounting faucetry and an integrated overflow. Shown as Air Bath

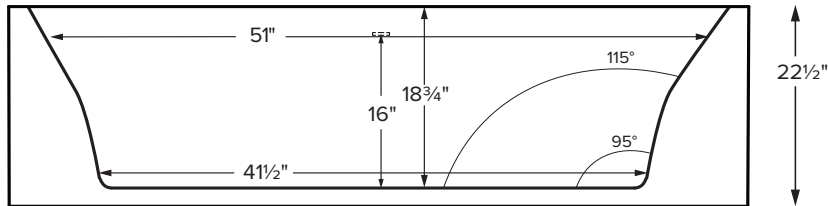

<b>ELECTRICAL COMPONENTS &amp; SPECIFICATIONS</b>		
Hydrotherapy Package	Components Included	GFCI/110V
<b>Microbubbles</b>	Microbubbles pump	1-15 amp
<b>Air Massage</b>	heated blower	1-15 amp
<b>Microbubbles with Air</b>	Microbubbles pump, heated blower	1-20 amp
<b>Air Massage Elite</b>	heated blower, chromatherapy	1-15 amp
<b>Microbubbles with Air Elite</b>	Microbubbles pump, heated blower, chromatherapy	2-15 amp

Electrical requirements may change with the addition of optional therapy components. See specific option details or installation information, CSA Certified C/US; B45.5/IAPMO ANSI Z124.1 and ANSI 112.19.7

See the Installation & Operation Manual for more details.  
MTI's Customer Service: Monday-Friday 8am-6pm EST  
**800-783-8827** or [service@mtibaths.com](mailto:service@mtibaths.com)

**IMPORTANT ORDERING & INSTALLATION INFORMATION**

- Before ordering or installing, please consider future access to equipment.
- Unless ordering Sculpted Finish on 4 sides, please include a diagram specifying which sides will need to be finished, along with location of optional tile flange(s).
- Integrated overflow with direct connect toe tap drain in chrome included. See manual for details.
- When ordering an air bath, the air blower must be remote mounted.
- Microbubbles system components must be installed on a non-Sculpted Finish side. Components will extend beyond the perimeter of the tub. Call MTI for specific details regarding the desired installation before placing the order.
- Radiance placed on floor locations will affect placement of air jets.
- Hydrotherapy equipment may ship loose for remote installation. See package content on the following page for details. Specifications and configurations are subject to change without notice.
- All tubs are compliant with ASTM C 1028-07 coefficient of friction. DoloMatte meets ANSI A137.1/A326.3 coefficient of friction and AS HB198:2014 slip tests.

• Options and accessories may be packaged inside the tub crate. Always check packaging before discarding.  
• All product measurements are ±1/2".  
• Specifications and configurations are subject to change without notice.  
• Measurements herein supersede all others published prior to publication date below.



Kahlo 1  
with Sculpted Finish®  
MODEL 119A  
60" x 36.25" x 22.5"

Hydrotherapy Packages	Package Contents	Sculpted Finish Sides	Acrylic CXL®		DoloMatte®	
			Part #	MSRP	Part #	MSRP
Soaker	Soaking bath - no jets, pre-leveled foam base, integrated slotted overflow with toe tap drain	4-sides sculpted	S119A4	\$8,605	S119D4	\$9,685
		3-sides sculpted	S119A3	\$7,960	S119D3	\$8,905
		2-sides sculpted	S119A2	\$6,425	S119D2	\$7,235
		1-side sculpted	S119A1	\$6,050	S119D1	\$6,725
Microbubbles	1 infusion port, microbubbles pump, pre-leveled foam base, integrated slotted overflow with toe tap drain	4-sides sculpted	n/a	n/a	n/a	n/a
		3-sides sculpted	M119A3	\$10,950	M119D3	\$11,895
		2-sides sculpted	M119A2	\$9,415	M119D2	\$10,225
		1-side sculpted	M119A1	\$9,040	M119D1	\$9,715
Air Massage	20 air jets, heated air blower, pre-leveled foam base, integrated slotted overflow with toe tap drain	4-sides sculpted	AST119A4	\$11,890	AST119D4	\$12,970
		3-sides sculpted	AST119A3	\$11,245	AST119D3	\$12,190
		2-sides sculpted	AST119A2	\$9,710	AST119D2	\$10,520
		1-side sculpted	AST119A1	\$9,335	AST119D1	\$10,010
Air Massage Elite	30 air jets, heated air blower, Chromatherapy LED lighting, Spa Mode, pre-leveled foam base, integrated slotted overflow with toe tap drain	4-sides sculpted	AE119A4	\$13,600	AE119D4	\$14,680
		3-sides sculpted	AE119A3	\$12,955	AE119D3	\$13,900
		2-sides sculpted	AE119A2	\$11,420	AE119D2	\$12,230
		1-side sculpted	AE119A1	\$11,045	AE119D1	\$11,720
Microbubbles with Air Massage	1 infusion port, microbubbles pump, 20 air jets, heated air blower, pre-leveled foam base, integrated slotted overflow with toe tap drain	4-sides sculpted	n/a	n/a	n/a	n/a
		3-sides sculpted	ASTM119A3	\$13,695	ASTM119D3	\$14,640
		2-sides sculpted	ASTM119A2	\$12,160	ASTM119D2	\$12,970
		1-side sculpted	ASTM119A1	\$11,785	ASTM119D1	\$12,460
Microbubbles with Air Massage Elite	1 infusion port, microbubbles pump, 30 air jets, heated air blower, Chromatherapy LED lighting, Spa Mode, pre-leveled foam base, integrated slotted overflow with toe tap drain	4-sides sculpted	n/a	n/a	n/a	n/a
		3-sides sculpted	AEM119A3	\$15,315	AEM119D3	\$16,260
		2-sides sculpted	AEM119A2	\$13,780	AEM119D2	\$14,590
		1-side sculpted	AEM119A1	\$13,405	AEM119D1	\$14,080

Microbubbles system components must be installed on a non-Sculpted Finish® side.

Components will extend beyond the perimeter of the tub. Call MTI for specific details regarding the desired installation before placing order.

For more customized applications, additional hydrotherapies may possibly be integrated in Sculpted Finish® tubs, depending on the types of therapy and the installation application. Visit [mtibaths.com](http://mtibaths.com) or call MTI at 800.783.8827.

RECOMMENDED SENSORY THERAPIES

**Chromatherapy**

(LE) **\$800** underwater lighting  
2 LED lights included

**Audiotherapy**

(STEREOBT) **\$1,390** 2 transducers with bluetooth and amplifier  
(BTREMOTE) **\$600** bluetooth remote

(STEREOH202) **\$1,575** 4 transducers  
amplifier not included

**Thermaltherapy**

(RAD100) **\$1,595** Radiance®  
2 heated zones included



For more information on options and accessories go to Acrylic Tub Options on mtibaths.com

Kahlo 1 with Sculpted Finish®  
MODEL 119A

<b>Options</b> <i>Must be ordered at time of purchase.</i>	
<b>Standard Color</b> White (CWH) gloss Acrylic CXL, matte DoloMatte	
<b>Textured, Slip-Resistant Bottom</b> (TXTBTM) <b>\$105</b> DoloMatte® exceeds ANSI A137.1/A326.3 and AS HB198 slip tests.	
<b>Ozonator</b> (OZONE) <b>\$515</b>	
<b>Virtual Spout</b> high-flow integrated tub filler (FPMJ) <b>\$450</b> <i>Must be located on same side as tub deck. Specify location when ordering.</i>	
<b>Installation Options</b> <i>Must be ordered at time of purchase.</i>	
<b>Tile Flange</b> Factory Installed rigid ABS	
1 Side (TFK1) <b>\$175</b>	<b>IMPORTANT:</b> <i>Must specify flange location(s) on order of Factory-Installed Flange.</i>
2 Sides (TFK2) <b>\$185</b>	
3 Sides (TFK3) <b>\$200</b>	
Field Install Kit (TFKNI) <b>\$185</b> Includes rigid ABS & adhesive	

<b>Accessories</b>	
<b>Pillows</b> from <b>\$180</b>	
<b>Teak Bath Mat</b> (TKMAT3018) <b>\$815</b> <i>Custom sizes also available. Contact MTI for details and pricing.</i>	
<b>Teak Tub Tray</b> Slatted (TK-TRAY1) <b>\$500</b> Solid (TK-TRAY2) <b>\$570</b>	
<b>Floor-Mounted High-Flow Tub Filler</b> Contemporary Chrome (FILLC) <b>\$1,480</b> Brushed Nickel (FILLBN) <b>\$1,710</b>	

**Drains & Overflow Kits** *Must be ordered at time of purchase*

<b>Integrated Overflow with Toe Tap</b>	
<b>Slotted Overflow</b> PVC drain - Chrome (SLOTIOC) included	
<b>Finish Upcharge</b>	
White (SLOTIOWHU) <b>\$65</b>	
Brushed Nickel (SLOTIOBNU) <b>\$65</b>	
Polished Nickel (SLOTIOPNU) <b>\$105</b>	

<b>Round Overflow</b> Chrome (RIOBC) may substitute slotted overflow	
<b>Finish Upcharge</b>	
White (RIOWH) <b>\$120</b>	
Brushed Nickel (RIOBN) <b>\$120</b>	
Polished Nickel (RIOPN) <b>\$120</b>	
<b>Brass Tailpiece</b> (WIOBS) <b>\$85</b> <i>May be ordered separately</i>	