

American Standard

# INSTALLATION INSTRUCTIONS

1660.771

1660.772

## SPECTRA+ HANDHELD™ KIT

For all Models

Thank you for selecting American Standard...  
the benchmark of fine quality for over 100 years.

To ensure that your installation proceeds smoothly-please read  
these instructions carefully before you begin.

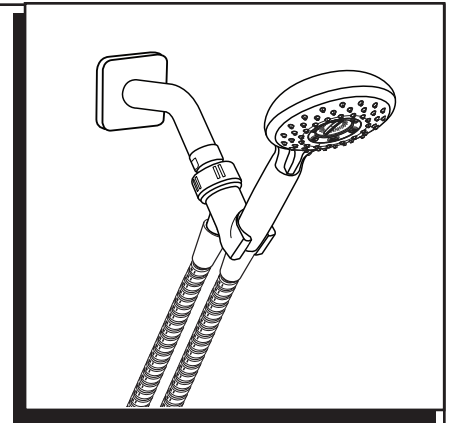

Certified to comply with ANSI A112.18.1M

### RECOMMENDED TOOLS AND MATERIALS

Most of the procedures require the use of common tools and materials, which are available from hardware and plumbing supply stores. It is essential that the tools and materials be on hand before work is begun.



Channel Locks



Adjustable Wrench



Teflon Tape



Plumbers' Grease

### CARE AND CLEANING

**Do:** Simply rinse the product clean with clear water, dry with a soft cotton flannel cloth.

**Do Not:** Clean the product with soaps, acid, polish, abrasives, harsh cleaners, or a cloth with a coarse surface.

## 1 INSTALL HAND HELD SHOWER, AND BRACKET TO SHOWER ARM WITH FLANGE

**CAUTION** Protect finish on HAND HELD SHOWER and ARM when installing.

- Operate handle back to front, in COLD and HOT positions, to flush water lines thoroughly.
- Apply sealant or Teflon tape to threads on SHOWER ARM (1).
- Thread BRACKET (4) onto the SHOWER ARM (1).
- Thread SHOWER HOSE (2) onto HAND SHOWER (3).
- Thread SHOWER HOSE (2) onto BRACKET (4).
- Place HAND HELD SHOWER (3) in BRACKET DOCK (5) to secure it in place.

**CAUTION: Protect finish on HAND HELD SHOWER and ARM when installing.**

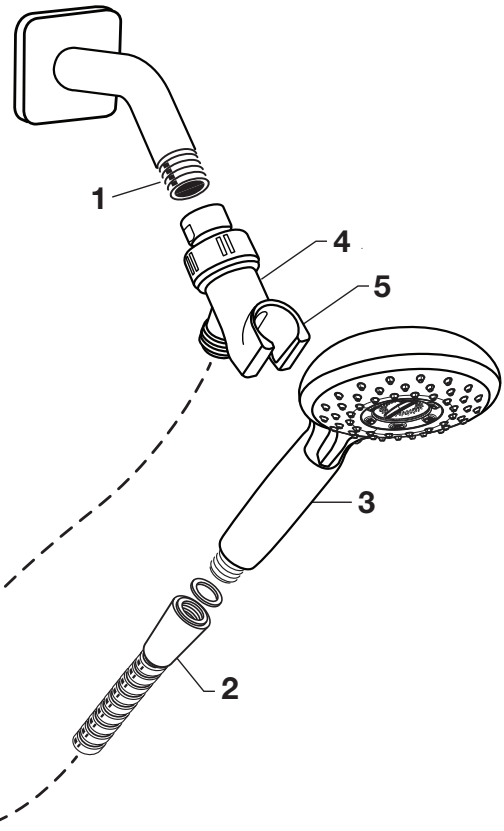

### HOT LINE FOR HELP

For toll-free information and answers to your questions, call:  
1 (800) 442-1902

Mon. - Fri. 8:00 a.m. to 8:00 p.m. EST  
Saturday 10:00 a.m. to 4:00 p.m. EST

IN CANADA 1-800-387-0369  
(TORONTO 1-905-306-1093)

Weekdays 8:00 a.m. to 7:00 p.m. EST

IN MEXICO 01-800-839-1200



PART OF LIXIL